

MoliCare® Premium Elastic

4-step fitting guide

HARTMANN



Standing Postion



- Measure the waist and hips - use the larger size.
- Choose correct product size - if between sizes try the smaller size first.
- Remove pads from packaging at least 1/2 hour before usage.
- Open up the brief lengthways, leaving the elasticated side panels in folded position.
- Fold and cup the product to get it ready for application.

Lying Postion

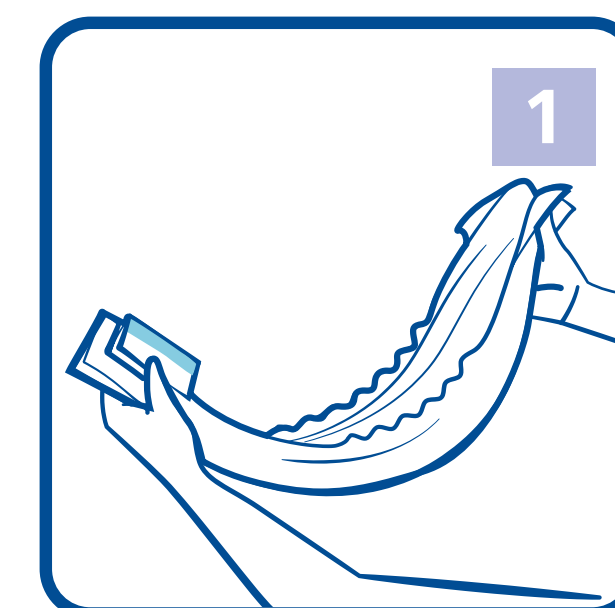

Standing Postion

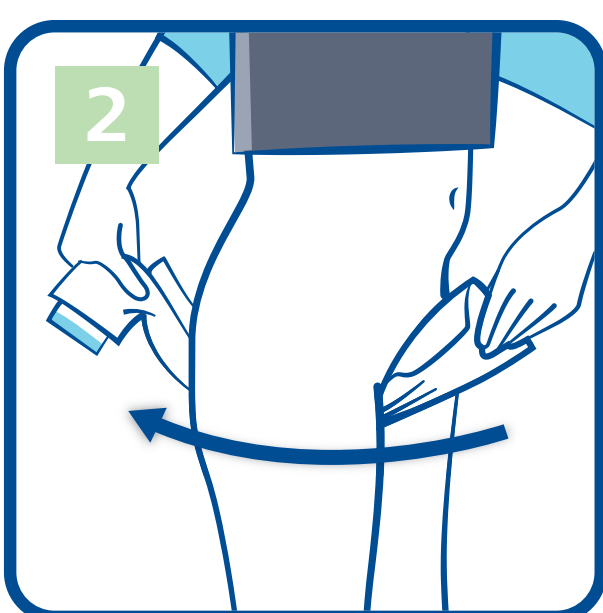

- Stand beside the patient. Slide the product between the legs from the front to the back.

- Ensure that the product is centred in the correct position by aligning the wetness indicator with the spine.

Lying Postion

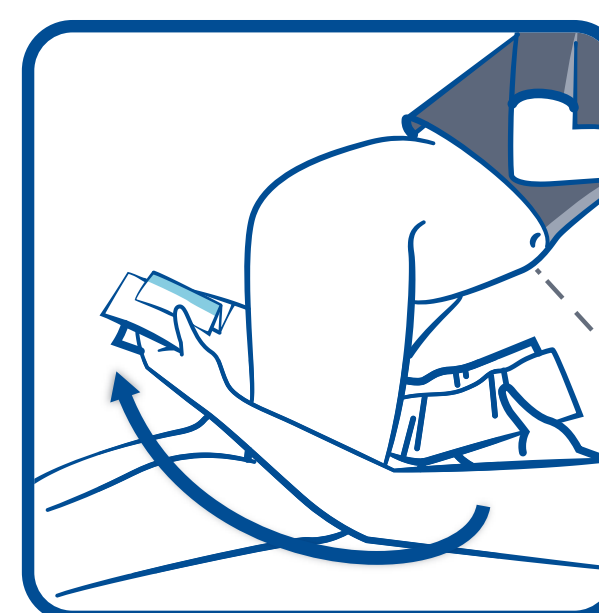

- Turn the patient on their side and slide the product between the legs from the front to the back.

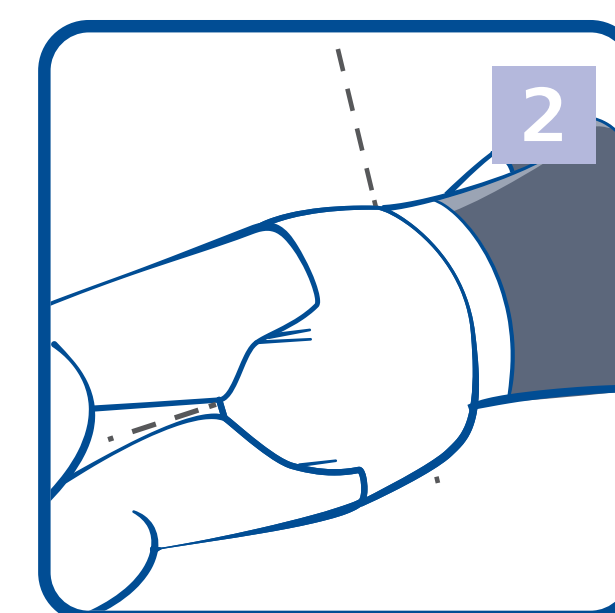

- Turn the patient onto their back.

Standing Postion

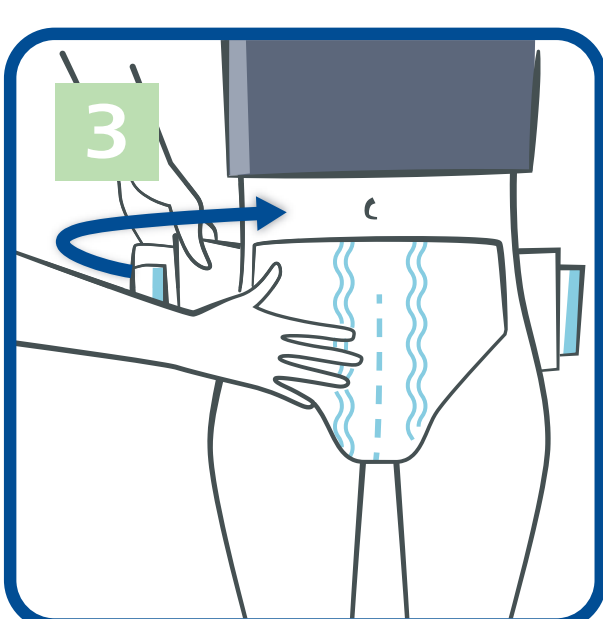

- Fold out the 1st side panel and wrap around the patient's hip.
- Secure the adhesive tape into position.

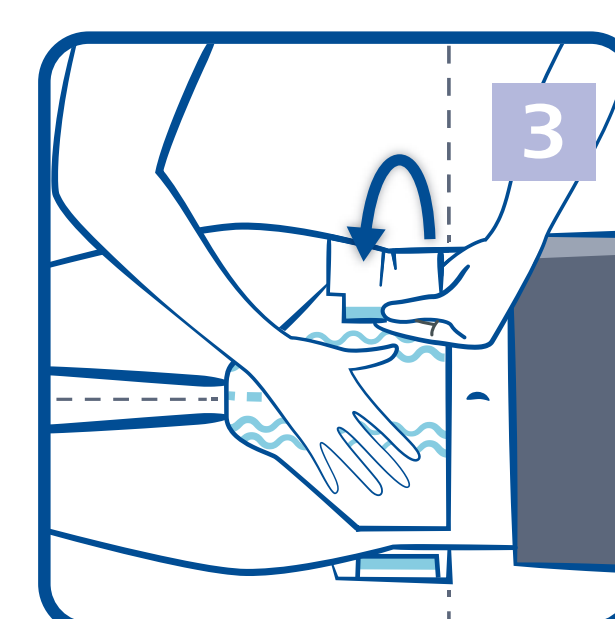
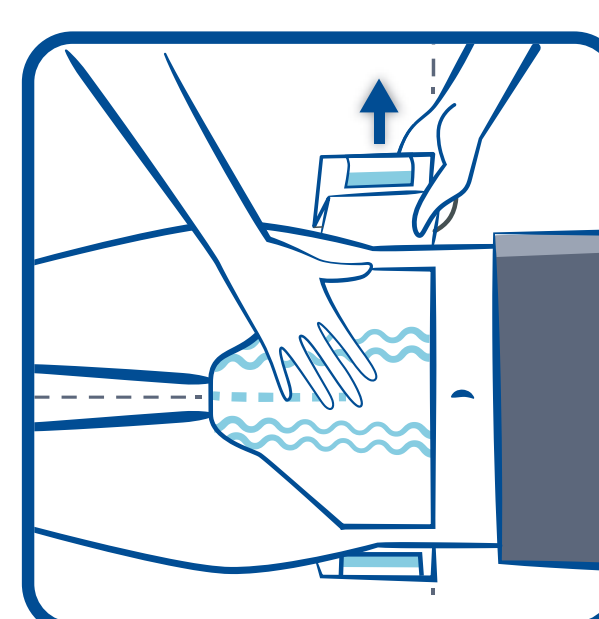

Standing Postion

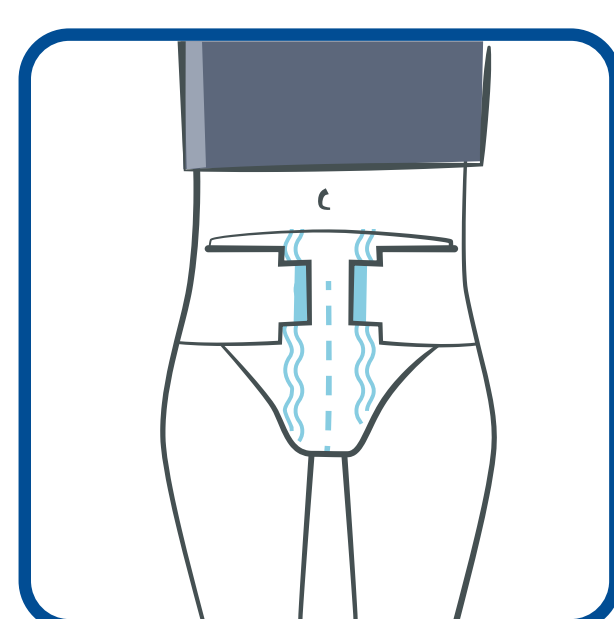

- Repeat on other side by folding out the 2nd side panel and wrap around the patient's hip.
- Secure the adhesive tape into position.

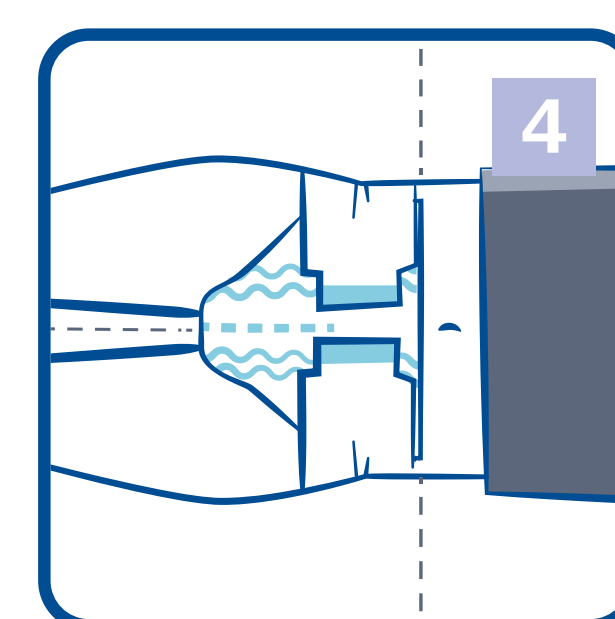
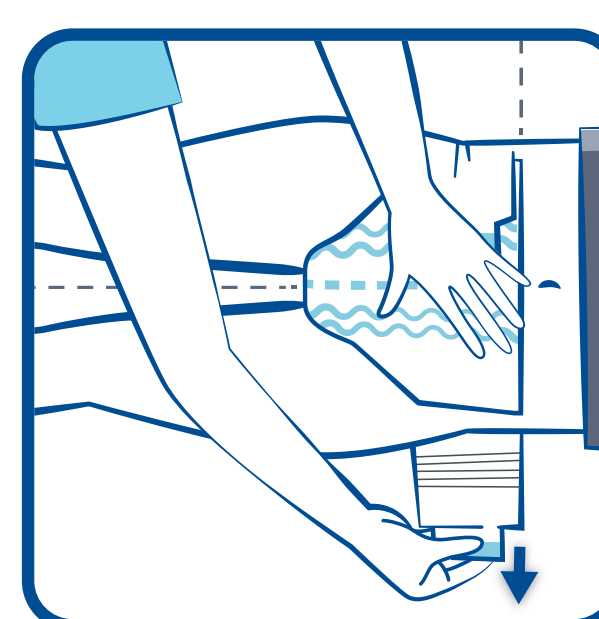

Find fitting videos and more in the link: <http://moli.care/elastic>

HARTMANN UK & Ireland | UK: +44 (0) 1706 363200 | Ireland: +353 (0) 1800 937766

info@uk.hartmann.info | www.hartmann.co.uk | www.hartmannirect.co.uk

©2019 Paul Hartmann Limited. Paul Hartmann Limited is a company registered in England and Wales (company number 01523121)

MoliCare® Premium Elastic

All-in-one incontinence slip **with 2 elasticated side panels and 2 re-closable hook & loop tapes** for moderate to very severe urinary and faecal incontinence

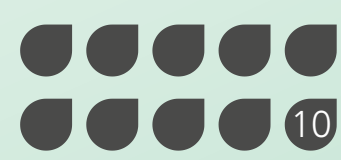

For moderate to very severe incontinence

Code	Absorbency Level	Size	Waist Measurement	Working Capacity	Pack Quantity
165 181	● 5 drops Extra	Small	70-90cm	930ml	30
165 182	● 5 drops Extra	Medium	85-120cm	1050ml	30
165 183	● 5 drops Extra	Large	115-145cm	1350ml	30
165 281	● 6 drops Extra Plus	Small	70-90cm	1040ml	30
165 282	● 6 drops Extra Plus	Medium	85-120cm	1240ml	30
165 283	● 6 drops Extra Plus	Large	115-145cm	1430ml	30
165 284	● 6 drops Extra Plus	X Large	140-175cm	1600ml	14
165 381	● 7 drops Super	Small	70-90cm	1170ml	30
165 382	● 7 drops Super	Medium	85-120cm	1440ml	30
165 383	● 7 drops Super	Large	115-145cm	1630ml	30
165 384	● 7 drops Super	X Large	140-175cm	1900ml	14
165 481	● 8 drops Super Plus	Small	70-90cm	1320ml	26
165 482	● 8 drops Super Plus	Medium	85-120cm	1700ml	26
165 483	● 8 drops Super Plus	Large	115-145cm	1870ml	24
165 484	● 8 drops Super Plus	X Large	140-175cm	2200ml	14
165 581	● 9 drops Maxi	Small	70-90cm	1350ml	26
165 582	● 9 drops Maxi	Medium	85-120cm	2290ml	26
165 583	● 9 drops Maxi	Large	115-145cm	2600ml	24
165 584	● 9 drops Maxi	X Large	140-175cm	2770ml	14
165 681	● 10 drops Maxi Plus	Small	70-90cm	1650ml	22
165 682	● 10 drops Maxi Plus	Medium	85-120cm	2450ml	14
165 683	● 10 drops Maxi Plus	Large	115-145cm	2800ml	14
165 684	● 10 drops Maxi Plus	X Large	140-175cm	3050ml	14



The use of oil or silicone based creams, or talcum powder on the skin may adversely affect the permeability of continence care products. The MoliCare® Skin range does not affect the permeability of continence care products.

To order additional products, go to www.hartmanndirect.co.uk
or call **+44 (0) 800 028 9490** from the UK and for Ireland: **+353 (0) 1800 937766**

